

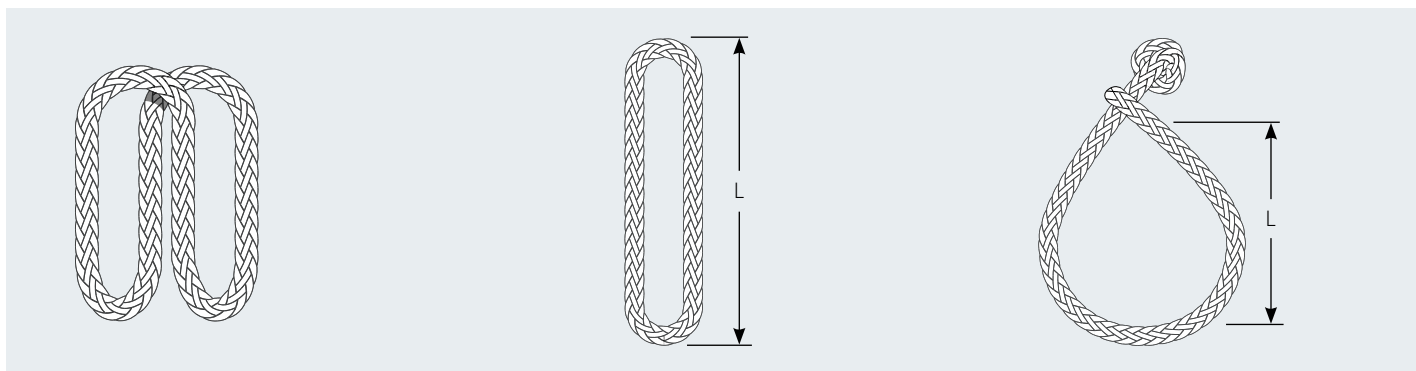

SOFT LINK



SOFT SHACKLE

World Class Yachting Ropes

Basket Load

Vertical Load

- ✔ Small diameter puller line allows for easy removal after soft shackle being loaded.
- ✔ Lightweight and easy on the boat.

- ✔ Alternative to traditional metal shackles.
- ✔ SK98 Dyneema® Soft Links.
- ✔ UHMWPE Soft Shackles.
- ✔ XG coating for UV stability and resistance to abrasion.

PRODUCT No.	DESCRIPTION	WHERE USED	DIAM. mm	L mm	B.L.* BASKET kg	B.L.* VERTICAL kg	WEIGHT g	DIAM. in	L in	B.L.* BASKET lb	B.L.* VERTICAL lb	WEIGHT oz
Soft Links												
RF9003-07	Soft Link	S30 Double & Triple, S40 Single & Fiddle Blocks	3.0	70	1200	600	1	1/8	2 3/4	2645	1320	0.1
RF9004-08	Soft Link	S40 Single & Fiddle, S55 Single & Fiddle Blocks	4.0	76	1800	900	1	5/32	3	2970	1985	0.1
RF9004-09	Soft Link	S40 Double & Triple Blocks	4.0	95	1800	900	2	5/32	3 3/4	2970	1985	0.1
RF9004-11	Soft Link		4.0	110	1800	900	2	5/32	4 11/32	2970	1985	0.1
RF9004-13	Soft Link	RC72541	4.0	128	1800	900	2	5/32	5 2/16	2970	1985	0.1
RF9005-10	Soft Link	S55 Double & Triple Blocks	5.0	100	2400	1200	3	3/16	3 15/16	5290	2645	0.1
RF9006-12	Soft Link		6.0	120	3400	1700	5	1/4	4 3/4	7495	3750	0.2
Soft Shackles												
DSH-2.5GRY	Soft Shackle		2.5	50	-	450	10	3/32	1 31/32	-	990	0.4
DSH-4GRY	Soft Shackle		4.0	65	-	1000	15	5/32	2 9/16	-	2200	0.6
DSH-6GRY	Soft Shackle		6.0	90	-	1700	18	1/4	3 17/32	-	3750	0.7
DSH-9GRY	Soft Shackle		9.0	100	-	3000	20	11/32	3 15/16	-	6610	0.7
DSH-12GRY	Soft Shackle		12.0	70	-	5000	40	1/2	2 3/4	-	11020	1.4
DSH-14GRY	Soft Shackle		14.0	100	-	7000	60	9/16	3 15/16	-	15430	2.2

* Considerations: Published breaking loads are based on as new condition. Fatigue, wear and UV exposure will deteriorate performance. Inspect regularly and replace if there are significant amount of wear or fibre damage. Attach to a mounting point with a smooth, well rounded profile without sharp edges or burrs.

OUTSIDE MOUNT
INSIDE MOUNT

RA554130



RA554131



RA435200



RA554136



RA554132

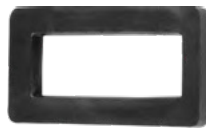
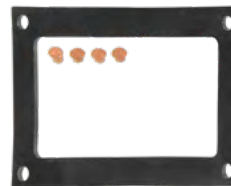

RA554133

 RA574153
RA574154

 RA574150
RA574151
RA574152

- ✔ Recognised as the industry standard for automatic bailers.
- ✔ Ingenious design uses venturi effect to produce suction and maximise water transfer – simply open the bailer when the boat is sailing at adequate speed to drain. Close when stationary or at low speed.
- ✔ Available in outside mount and inside mount models.
- ✔ Inside mount models have a plastic grate to prevent lines being sucked out.
- ✔ Robust stainless steel construction, provides long trouble free service life.
- ✔ Bailer and service kit installation instructions are available in the SUPPORT section at www.ronstan.com.
- ✔ Effective means of automatic bailing for dinghies and small one design keelboats.
- ⚙ Install on port and starboard sides for optimum bailing on both tacks.
- ⚙ RA435200 Super Mini Special bailer is designed for racing dinghies where the bailer is operated from a hiking position.
- ⚙ Stainless steel construction.
- ⚙ Rubber gaskets.

PRODUCT No.	DESCRIPTION	SIZE OF DRAINAGE OPENING mm ²	FLANGE SIZE mm	CUTOUT HOLE mm	NOMINAL HULL THICKNESS mm	WEIGHT g	SIZE OF DRAINAGE OPENING in ²	FLANGE SIZE in	CUTOUT HOLE in	NOMINAL HULL THICKNESS in	WEIGHT oz	SERVICE KIT
Bailers - Outside Mount												
RA554130	Mini	255	56 x 92	38 x 73	4	100	0.395	2 1/4 x 3 5/8	1 1/2 x 2 7/8	5/32	3.5	RA574153
RA554136	Large	435	80 x 142	41 x 104	4	275	0.674	3 3/16 x 5 9/16	1 5/8 x 4 1/8	5/32	9.7	RA574154
Bailers - Inside Mount												
RA435200	Super Mini Special*	250	61 x 106	40 x 85	7	175	0.387	2 7/16 x 4 3/16	1 5/8 x 3 3/8	1/4	6.2	RA574150
RA554131	Super Mini	250	61 x 106	40 x 85	7	175	0.387	2 7/16 x 4 3/16	1 5/8 x 3 3/8	1/4	6.2	RA574150
RA554132	Super Medium	350	67 x 135	43 x 110	7	275	0.543	2 11/16 x 5 5/16	1 3/4 x 4 3/8	1/4	9.7	RA574151
RA554133	Super Max	540	78 x 135	54 x 110	7	320	0.837	3 1/8 x 5 5/16	2 1/8 x 4 3/8	1/4	11.3	RA574152
Service Kits												
RA574150	Service kit to suit Super Mini bailer (RA54131). Includes internal and external gaskets, rivets											
RA574151	Service kit to suit Super Medium bailer (RA554131). Includes internal and external gaskets, rivets											
RA574152	Service kit to suit Super Max bailer (RA554133). Includes internal and external gaskets, rivets											
RA574153	Service kit to suit Mini bailer (RA554130). Includes internal gasket											
RA574154	Service kit to suit Large bailer (RA554136). Includes internal gasket											

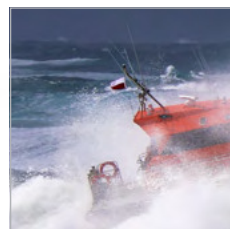
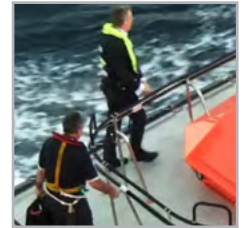
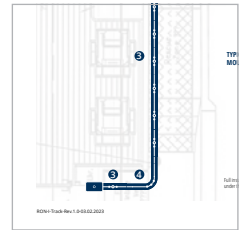
*Super Mini Special is designed for racing dinghies where the bailer is operated from a hiking position using a control line.



WORK BOAT SAFETY SYSTEM

INCREASED PROTECTION & CREW SAFETY

The Ronstan Series 32 I-Track Safety System is designed to provide protection and safety for crew on commercial work boats when working on deck or outside the safety of the vessel's cabin.

The system has been tried and proven on many commercial vessels including but not limited to pilot boats, fire and rescue boats, police and military patrol boats and commercial fishing boats.

The safety system provides a method of attachment for use in conjunction with personal fall protection equipment to protect crew against falls and overboard situations and allows freedom to move about the work boat uninhibited and with ease in any sea conditions.

Thoroughly tested at the factory and in the field, our Series 32 I-Track Safety System meets the requirements of the Australian National Standards for Commercial Vessels (NSCV), Part C, Section 1, 6.17.3 (Pilot Launch – Equipment) and 6.12.7.5.6 (Clipping point strength).

MODULAR SYSTEM FOR EASE OF SPECIFICATION AND INSTALLATION

To achieve greater economy with the flexibility to adapt, we have created a modular system of standard components that make it easy to design, specify and install these systems to a wide range of commercial vessels.

For designers and builders, 2D and 3D drawings are available to assist and ensure it's a Ronstan Safety System that you next specify. Customised track rails are available for vessels where standard track rail corners are not suitable.

Features

- Track rails, rigid profile, marine grade black anodised aluminium (AL6061-T6).
- Track rails available in standard straight and curved lengths easily adapted to suit many work boat deck plans.
- 90-degree corner, 500mm radius bend can be trimmed to adapt to the required angle. These are primarily used for corners found at the front of the cabin.
- 90-degree corner, 125mm radius bend. These tight radius corners are excellent for applications where space on the side deck is limited or where track rails need to traverse around sharp corners.
- 15-degree track rail deflection lengths. These can be used where angle changes occur along the cabin side.
- Cars have strong grade 316 stainless steel bodies with flared sides and angled stainless steel bearing wheels to provide high load capacity, smooth operation, and require minimal maintenance.
- Cars are available in free running and plunger lock configurations with large lanyard take off points for easy attachment.

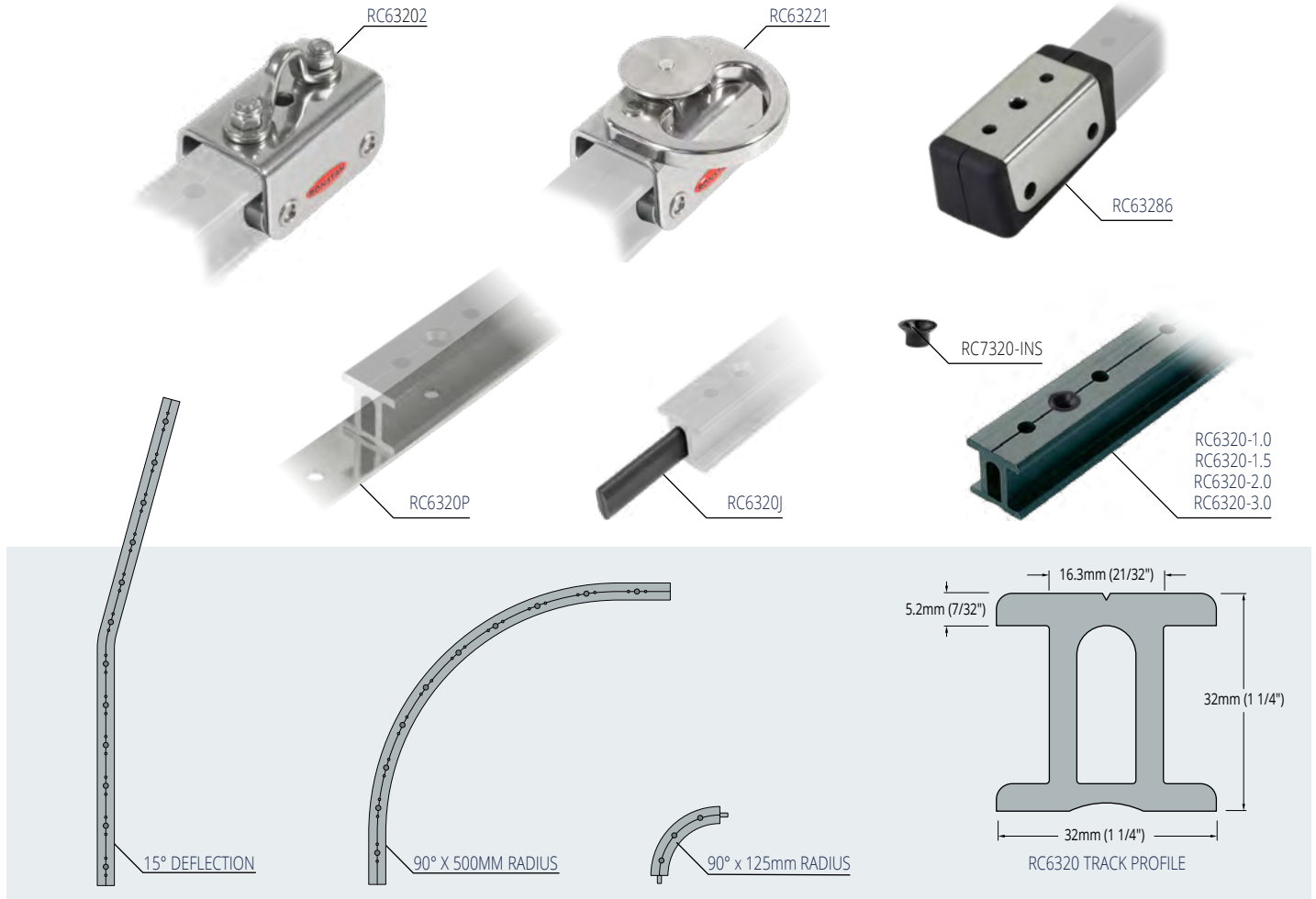

- ✔ Strong stainless steel bodies.
- ✔ Flared sides and angled ball bearing wheels provide high load capacity and smooth operation.
- ✔ Please see ronstan.com for custom track bending.

- ✔ Meets the requirements of the Australian National Standards for Commercial Vessels (NSCV), Part C, Section 1, 6.17.3 (Pilot Launch – Equipment) and 6.12.7.5.6 (Clipping point strength).

- ⬆ Commercial work boats and pilot boats.
- ⚙ Grade 316 stainless steel car bodies, wheels, bearing races, and fixtures.
- ⚙ Grade AL6061-T6 aluminium alloy track.

TRACK FASTENINGS – M6 (1/4") countersunk fasteners at 100mm (3 15/16") centres. Unsupported fastening span no greater than 1500mm (59 1/16"). Each span or join must be supported by a minimum of two fastenings at each end at a maximum of 100mm (3 15/16") centres.

Grade 316 stainless steel fasteners with a nominal minimum strength of 700MPa (101ksi), installed at a torque setting of no more than 7.1Nm (5.2 ft lbf) as per industry standards.

Strength of substrate, backing plates, brackets must be designed to support a minimum 600kg (1320lb) ultimate static load.

STOP HOLES – 50mm (2") centres.

Full installation, usage and maintenance details available under the SUPPORT tab at www.ronstan.com.

PRODUCT No.	DESCRIPTION	LENGTH	WEIGHT	LENGTH	WEIGHT
		mm	g	in	oz
Series 32 I-Track Safety System					
RC63202	Car, saddle top	76	320	3	11.3
RC63221	Car, single attachment point, plunger stop	76	461	3	16.3
RC63286	End stop, rubber buffer	98	260	3 7/8	9.2
Track – Supplied with RC7320-INS nylon track bolt insulators					
RC6320-1.0*	Track, 996mm (39 3/16"), black	996	1210	39 3/16	42.8
RC6320-1.5*	Track, 1496mm (58 7/8"), black	1496	1810	58 7/8	64.0
RC6320-2.0*	Track, 1996mm (78 9/16"), black	1996	2410	78 9/16	85.2
RC6320-3.0*	Track, 2996mm (117 15/16"), black	2996	3620	117 15/16	127.9
RC6320R125A	Track, 293mm (11 9/16"), black, 90° x 125mm radius, horizontal A-bend	293	444	11 9/16	15.7
RC6320R500A*	Track, 1196mm (47 1/16"), black, 90° x 500mm radius, horizontal A-bend	1196	1470	47 1/16	51.8
RC6320R515A*	Track, 1996mm (78 9/16"), black, 15° deflection, horizontal A-bend	1996	2410	78 9/16	85.2
RC6320P	Track splice plate, stainless steel	340	255	13 3/8	9.0
RC6320J	Track joiner	90	14	3 9/16	0.5
RC7320-INS	Track bolt insulator	-	3	-	0.1

*For standard length track rails, as delivered from the manufacturer, the centre of the last mounting hole at each end of the track rail is located at 48mm (1 29/32") from the end, and the distance between fasteners across a track join will be 96mm (3 25/32"). The distance between the two fasteners at the end of each track rail, whether across a join or at an end, must never exceed 100mm (3 15/16").



Swivelling & pivoting shackle head

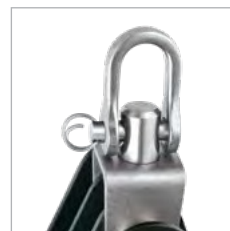

Clevis pin shackle option

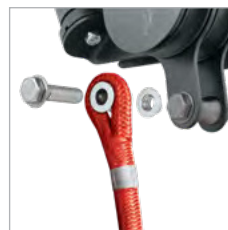

Removable becket pins

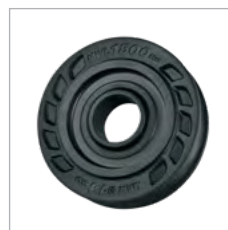

Durable, UV stabilised sheaves



Aluminium Rope/Wire sheave (S75)

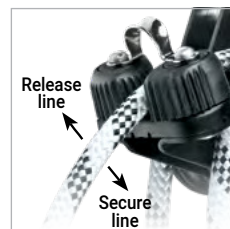

Simple and secure rope cleating

INDUSTRIAL PULLEY BLOCKS

INDUSTRIAL GRADE CONSTRUCTION, RELIABILITY & PERFORMANCE

Ronstan's Industrial Pulley Blocks offer a high quality, reliable solution for a myriad of applications. Full stainless steel housings and attachment fittings provide ultimate durability, long service life and resistance to harsh environments. Self-lubricating acetal polymer sheaves running on polished stainless steel races perform equally well with dynamic loads and high static loads, and an alloy sheave option is available for use with wire rope. Ronstan Industrial Blocks are load rated and are backed by a full factory warranty.

Swivelling and pivoting shackle head

Allows easy attachment and correct alignment of the pulley block. Shackle pins are drilled for use of security wire. The option of shackle with clevis pin and retaining ring is available in Series 75 - order as RZxxxxC. Provides tool-free attachment and removal.

Removable becket to suit pre-spliced lines

Pre-spliced lines are neat, compact and provide greater security and strength than knotted terminations. Becket on all Ronstan Industrial Blocks are removable to accommodate the use of pre-spliced lines.

Simple and secure rope holding

Blocks fitted with cam cleats provide a simple means of holding the rope. Just pull the rope through the spring-loaded jaws, which prevent the rope from slipping back. Flick the rope up and out of the jaws to release. A stainless steel eye strap keeps the rope in position ready for re-cleating.

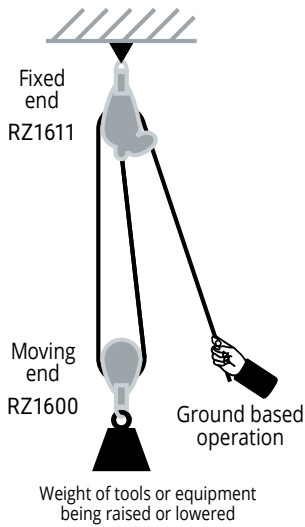
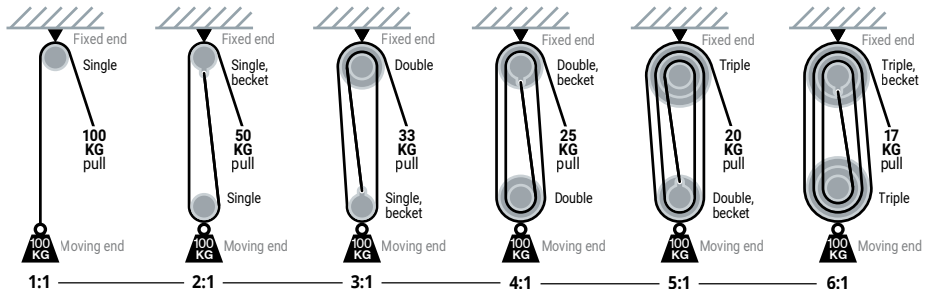
TYPICAL PURCHASE SYSTEMS
MECHANICAL ADVANTAGE*

- ✔ Load rated.
- ✔ Fully articulating head/attachment.
- ✔ Durable, low friction acetal polymer sheave.

- ✔ RZ1611 has a cleating angle of 60° from the mounting plane and is ideal for 'remote' operation as in the case of a ground based assistant raising tools or equipment to an overhead worker.
- ✔ UV stabilised acetal sheaves.

- ✔ Grade 316 stainless steel side plate/cheeks, powder coated black.
- ✔ Fibre reinforced polymer rope cleats.
- ✔ Grade 316 stainless steel head, shackle, becket and fastenings.

PRODUCT No.	DESCRIPTION	SHEAVE DIAM.	MAX. ROPE	PIN DIAM.	M.W.L.	B.L.	WEIGHT	SHEAVE DIAM.	MAX. ROPE	PIN DIAM.	M.W.L.	B.L.	WEIGHT
		mm	mm	mm	kg	kg	g	in	in	in	lb	lb	oz
Industrial Pulley Blocks													
RF617H	Shackle, 6mm (1/4") screw pin with security wire hole	-	-	6	1000*2	2000*2	25	-	-	1/4	2200*2	4410*2	0.9
RZ1600	Single block, swivel shackle head	60	12	6	1000	2000	390	2 3/8	1/2	1/4	2200	4410	13.8
RZ1603	Single block, becket, swivel shackle head	60	12	6	1000	2000	460	2 3/8	1/2	1/4	2200	4410	16.3
RZ1607	Single block, becket, 30° cleat, swivel shackle head	60	12	6	600*1	2000	705	2 3/8	1/2	1/4	1320*1	4410	24.9
RZ1611	Single block, becket, 60° cleat, swivel shackle head	60	12	6	600*1	2000	795	2 3/8	1/2	1/4	1320*1	4410	28.1

*1 MWL based on maximum allowable line load through cleat of 300kg (660lb), 2:1 purchase.

*2 Uniformly distributed load on shackle; i.e. load applied across the full width of the shackle pin. See page 200 for full details.



PRODUCT No.	DESCRIPTION	SHEAVE	MAX.	PIN	M.W.L.	B.L.	WEIGHT	SHEAVE	MAX.	PIN	M.W.L.	B.L.	WEIGHT
		DIAM.	ROPE	DIAM.	kg	kg	g	DIAM.	ROPE	DIAM.	lb	lb	oz
		mm	mm	mm				in	in	in			
Industrial Pulley Blocks													
RZ1700	Single block, swivel shackle head	75	14	8	1500	3000	630	3	9/16	5/16	3300	6600	22.2
RZ1700AW	Single block, swivel shackle head, aluminium rope/wire sheave	75	8	8	1500	3000	740	3	5/16	5/16	3300	6600	26.1
RZ1703	Single block, becket, swivel shackle head	75	14	8	1500	3000	730	3	9/16	5/16	3300	6600	25.7
RZ1705	Double block, swivel shackle head	75	14	8	1500	3000	940	3	9/16	5/16	3300	6600	33.2
RZ1706	Double block, becket, swivel shackle head	75	14	8	1500	3000	1040	3	9/16	5/16	3300	6600	36.7
RZ1708	Triple block, swivel shackle head	75	14	8	1500	3000	1240	3	9/16	5/16	3300	6600	43.7
RZ1709	Triple block, becket, swivel shackle head	75	14	8	1500	3000	1325	3	9/16	5/16	3300	6600	46.7

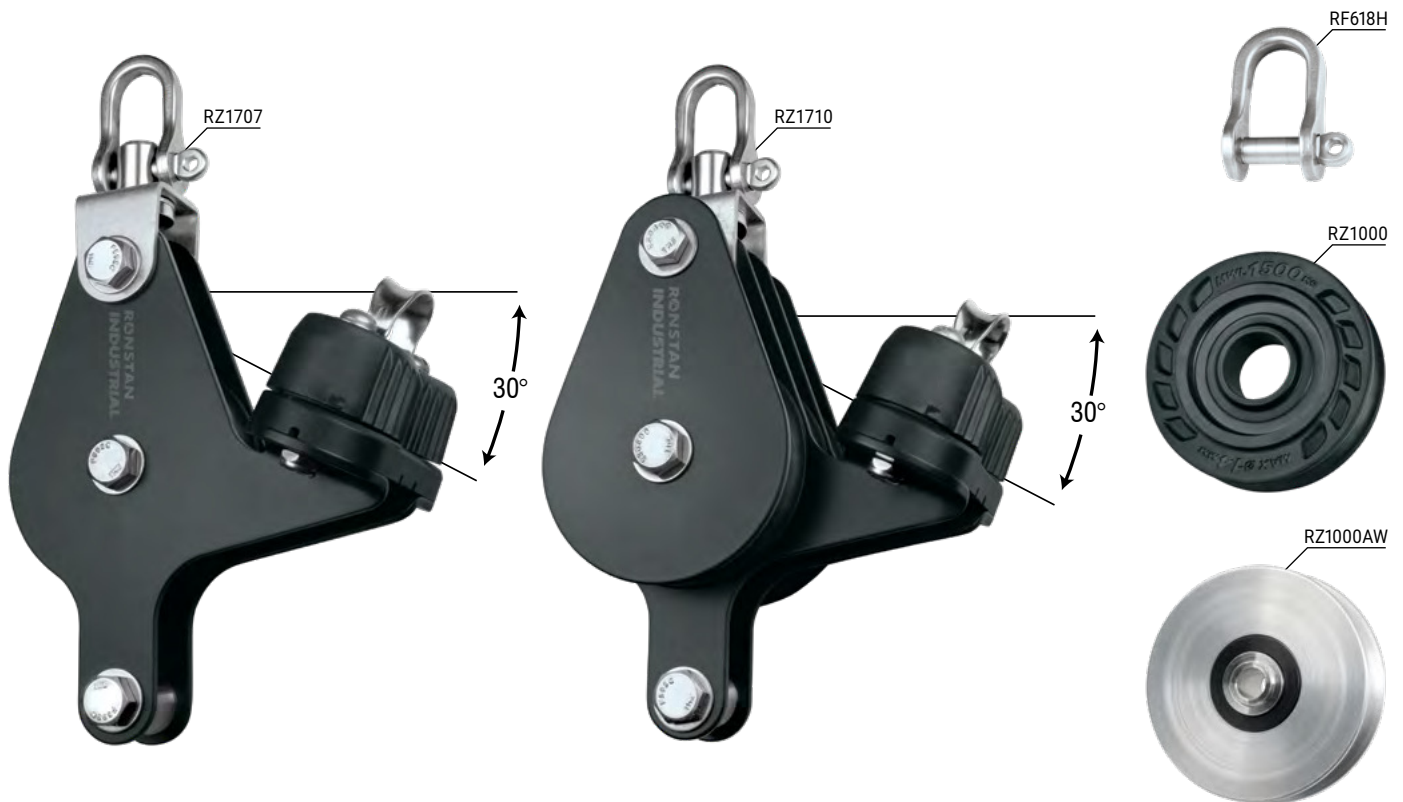

- ✔ Load rated.
- ✔ Fully articulating head/attachment.
- ✔ Easy to service removable sheaves (bolt & nylon-insert nut).
- ✔ Durable, low friction acetal polymer sheave.
- ✔ Heavy duty aluminium sheave models available ('AW' suffix) or by conversion with RZ1000AW sheave.
- ✔ Blocks available to order with clevis pin and retaining ring shackle head.
- ✔ UV stabilised acetal sheaves.
- ✔ Aluminium sheave on 'AW' models.
- ✔ Grade 316 stainless steel side plate/cheeks, powder coated black.
- ✔ Fibre reinforced polymer rope cleats.
- ✔ Grade 316 stainless steel head, shackle and fasteners.

PRODUCT No.	DESCRIPTION	SHEAVE DIAM.	MAX. ROPE	PIN DIAM.	M.W.L.	B.L.	WEIGHT	SHEAVE DIAM.	MAX. ROPE	PIN DIAM.	M.W.L.	B.L.	WEIGHT
		mm	mm	mm	kg	kg	g	in	in	in	lb	lb	oz
Industrial Pulley Blocks													
RZ1707	Single block, becket, 30° cleat, swivel shackle head	75	14	8	600* ¹	3000	955	3	9/16	5/16	1320* ¹	6600	33.7
RZ1710	Triple block, becket, 30° cleat, swivel shackle head	75	14	8	1500* ²	3000	1565	3	9/16	5/16	3300* ²	6600	55.2

PRODUCT No.	DESCRIPTION	SHEAVE DIAM.	MAX. WIRE	MAX. ROPE	M.W.L.	B.L.	WEIGHT	SHEAVE DIAM.	MAX. WIRE	MAX. ROPE	M.W.L.	B.L.	WEIGHT
		mm	mm	mm	kg	kg	g	in	in	in	lb	lb	oz
Accessories													
RF618H	Shackle, 7.9mm (5/16") diameter screw pin with security wire hole	-	-	-	1500* ³	3300* ³	50	-	-	-	3300* ³	6600* ³	1.5
RZ1000	Sheave, acetal (POM)	75	-	14	-	-	70	3	-	9/16	-	-	2.5
RZ1000AW	Sheave, aluminium with composite bearing	75	8	-	-	-	180	3	9/16	-	-	-	6.4

*1 MWL based on maximum allowable static line load through cleat of 300kg (660lb), 2:1 purchase. Controlled release of loaded line will only be possible at lower loads that are within the user's capability for manual handling.

*2 Line load not to exceed static load of 300kg through cleat. Controlled release of loaded line will only be possible at lower loads that are within the user's capability for manual handling.

*3 Uniformly distributed load on shackle; i.e. load applied across the full width of shackle pin. See page 200 for full details.

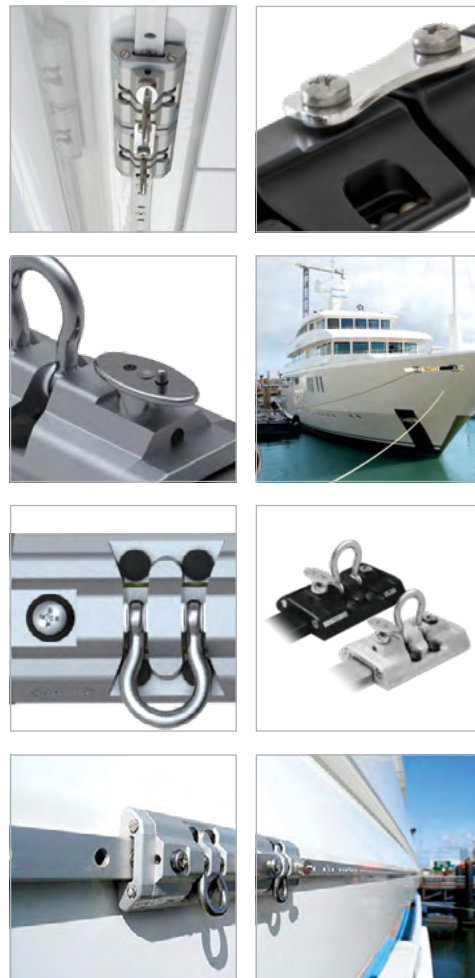

SAFETY RAIL SYSTEMS

A HIGHER STANDARD OF SAFETY

Track and car systems and single point anchorage systems have long been used to provide a mobile attachment point for crew when cleaning the hull, superstructure and windows of large motor yachts and other vessels.

With today's greater awareness of workplace risks, boat builders and surveyors are seeking to ensure a high standard of safety by specifying systems that are purpose designed, tested and standards-approved.

Ronstan supports this approach, which can only improve the safety and security of the persons using these systems in their everyday work, and has developed Safety Rail & Single Point Anchorage systems which have been tested to the relevant European and Australian Standards. Testing for conformity to these standards is witnessed by a Recognised Organisation, member of the International Association of Classification Societies (IACS).

Purpose

Ronstan Fall Protection Systems provide a method of attachment for use in conjunction with personal protection equipment to protect against falls from a height, such as when working outside of conventional guardrails for cleaning and maintenance purposes on motor yachts or other vessels. They should not be used for any other purpose.

Features

SAFETY RAIL SYSTEMS

- Certified to European Standard EN795:2012, Type D for single person use (S22 system also certified to European Technical Specification CEN/TS16415:2013 Type D for multiple users and Australian Standard AS1891.2:2001, Part 2).
- Marine grade aluminium alloy cars, track rails and end stops, anodised for corrosion protection and long service life.
- Recirculating Torlon® ball bearings for free running, low friction performance and low maintenance.
- Grade 316 forged stainless steel pivoting shackles for lanyard attachment.
- Rubber buffers for reduced vibration and to lift pivoting shackles away from car body for quick access.
- Spring-loaded stainless steel plunger for simple, positive repositioning at stop locations. Can be locked in the disengaged position to allow free movement along the track rail. The elliptical knob is easy to grip and turn, and indicates clearly whether the plunger is engaged or not.

SINGLE POINT ANCHORAGE SYSTEMS

- Removable Screw-In padeye anchorages are certified to the European standard EN795:2012, Type A, for single person use, as well as the Australian standards AS1891.4.2009 & AS5532:2013.
- Marine grade 316 stainless steel structural anchor base, screw-in anchor device and identification plate.
- Identification plate features the unique serial number.
- The screw-in anchor device can be removed from the structural anchor base when not in use for safety or maintenance. It should always be locked to the base when in use with the locking screw.

SAFETY RAIL SYSTEM SYSTEM DESCRIPTION

The complete Safety Rail System consists of the following components:

- One track rail with stop holes at 50mm centres and mounting holes at 100mm centres (centre of the last mounting hole at each end of the track rail is located 48mm from the end).
- A single car assembly for an S30 system, or for a S22 system a maximum of 3 independent car assemblies, with each car assembly dedicated to an individual user and incorporating a spring-loaded plunger.
 - Each individual car has a single attachment point for personal protection equipment.
 - The spring-loaded plunger allows the car assembly to be fixed in position at any of the stop holes in the track rail. The plunger can be disengaged to allow the free movement of the car assembly along the rail.
- Two end stops installed at the extremities of the track rail.

OPTIONS

- Longer runs can be achieved by using more than one section of track rail and trimming to length as required, provided that the distance between mounting fasteners never exceeds 100mm. The joining insert should be used to aid alignment when fitting multiple sections of track rail.
- Additional sliding cars for supporting tools or equipment can be connected to the main tandem car with the connector plate.
- Optional end stop cover plates.
- Black or silver anodised cars and track.

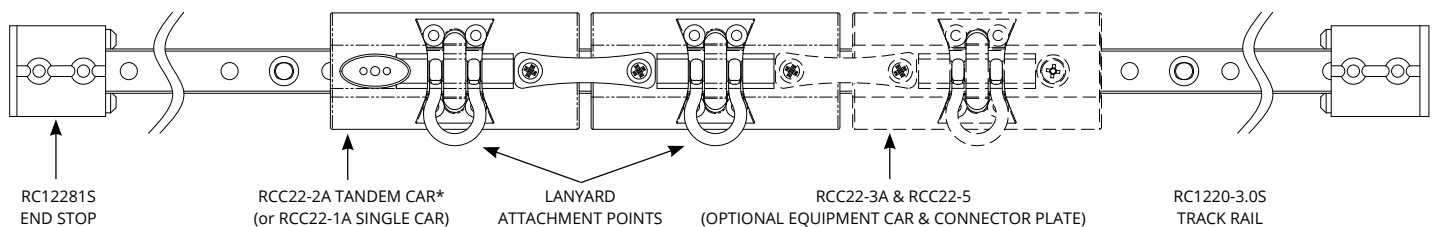

* Tandem car is required if the user's weight while working or accessing the work site is supported by the car, as the tandem car provides separate attachment points for both the working line and fall arrest safety line, as recommended in the EN363 standard: Personal fall protection equipment - Personal fall protection systems.



TRACK RAIL MOUNTED IN VERTICAL PLANE



TRACK RAIL MOUNTED IN HORIZONTAL PLANE

IMPORTANT ADVICE

Ronstan Fall Protection Systems are tested and certified to relevant European and Australian Standards, and are appropriate for single person use (or, for S22 Safety Rail Systems, up to a maximum of three simultaneous users, with one dedicated car for each individual user) with an energy absorber to the EN355 standard. Testing for conformity to these standards is witnessed by a Recognised Organisation, member of the International Association of Classification Societies (IACS).

These systems must only be used with personal protection equipment (harnesses, lanyards, fall arresters and other devices) that are approved to the relevant standards for such equipment, such as EN363. Each harness or device must be secured to a separate attachment point. Full product range details can be found at www.ronstan.com. Installation, usage and maintenance information is available under the **SUPPORT** tab on the site.



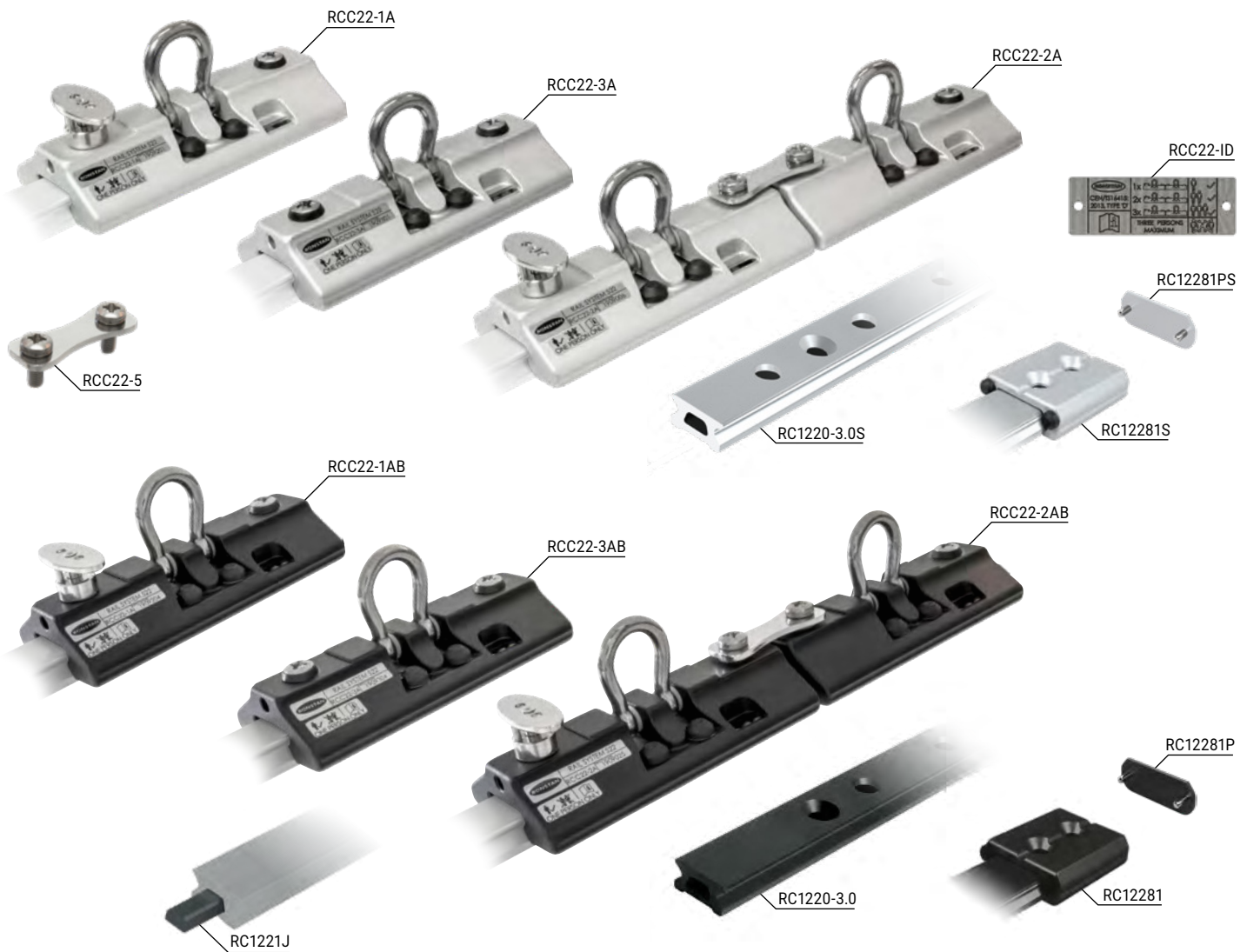

Full installation, usage and maintenance details available under the **SUPPORT** tab at www.ronstan.com.

- ✔ Certified to European Standard EN795:2012 Type D and European Technical Specification CEN/TS16415:2013 Type D for a maximum of three simultaneous users, and Australian Standard AS1891.2:2001, Part 2.
- ✔ Low friction.
- ✔ Anti-clatter rubber buffers.
- ✔ Lock up/down track position plunger stop.
- ✔ Anodised aluminium car bodies and track.
- ✔ Torlon® ball bearings.
- ✔ Grade 316 shackle, plunger stop, pivot pin, fasteners and connector plate.

PRODUCT No.	DESCRIPTION	LENGTH	WIDTH	WEIGHT	LENGTH	WIDTH	WEIGHT
		mm	mm	g	in	in	oz
Series 22 Safety Rail System							
RCC22-1A	Single car, 1 attachment point, plunger stop, silver	124	58	252	4 7/8	2 5/16	8.9
RCC22-1AB	Single car, 1 attachment point, plunger stop, black	124	58	252	4 7/8	2 5/16	8.9
RCC22-2A	Tandem car, 2 attachment points, plunger stop, silver	254	58	504	10	2 5/16	17.8
RCC22-2AB	Tandem car, 2 attachment points, plunger stop, black	254	58	504	10	2 5/16	17.8
RCC22-3A	Single car, 1 attachment point, silver	124	58	234	4 7/8	2 5/16	8.3
RCC22-3AB	Single car, 1 attachment point, black	124	58	234	4 7/8	2 5/16	8.3
RCC22-5	Connector plate, including screws	-	-	37	-	-	1.3
RC1221J	Track rail joiner	-	-	4	-	-	0.1
RC12281S	Track rail end stop, silver	50	45	50	1 31/32	1 25/32	1.8
RC12281	Track rail end stop, black	50	45	50	1 31/32	1 25/32	1.8
RC1220-3.0S	Track rail, silver, 2996mm	2996	22	1380	117 15/16	7/8	48.7
RC1220-3.0	Track rail, black, 2996mm	2996	22	1380	117 15/16	7/8	48.7
RC12281P	End stop cover plate, including screws, black	-	45	5	-	1 25/32	0.2
RC12281PS	End stop cover plate, including screws, silver	-	45	5	-	1 25/32	0.2
RCC22-ID*	CEN/TS16415:2013 Type 'D' Multi-User Identification Plate	88	30	-	3 15/32	1 3/16	-

* If multiple car assemblies are installed on a continuous run of track rail, the multi-user ID plate RCC22-ID must be displayed at the user entry point(s) of the system (typically adjacent to an end stop), to indicate the maximum number of simultaneous users allowed.



Full installation, usage and maintenance details available under the **SUPPORT** tab at www.ronstan.com.

- ✔ Certified to European Standard EN795:2012 Type D for single person use..
- ✔ Low friction.
- ✔ Anti-clatter rubber buffers.
- ✔ Lock up/down track position plunger stop.
- ✔ Suitable for curved track installations with a radius of no less than 2500mm (8'2")
- ✔ Anodised aluminium car bodies and track.
- ✔ Torlon® ball bearings.
- ✔ Grade 316 shackle, plunger stop, pivot pin, fasteners and connector plate.

PRODUCT No.	DESCRIPTION	LENGTH	WIDTH	WEIGHT	LENGTH	WIDTH	WEIGHT
		mm	mm	g	in	in	oz
Series 30 Safety Rail System							
RCC22-4	Connector plate, including screws	-	-	37	-	-	1.3
RCC30-1A	Single car, 1 attachment point, plunger stop, silver	104	77	364	4 1/8	3	12.9
RCC30-1AB	Single car, 1 attachment point, plunger stop, black	104	77	364	4 1/8	3	12.9
RCC30-2A	Tandem car, 2 attachment points, plunger stop, silver	215	77	720	8 1/2	3	25.4
RCC30-2AB	Tandem car, 2 attachment points, plunger stop, black	215	77	720	8 1/2	3	25.4
RCC30-3A	Single car, 1 attachment point, silver	104	77	328	4 1/8	3	11.6
RCC30-3AB	Single car, 1 attachment point, black	104	77	328	4 1/8	3	11.6
RC1301J	Track rail joiner	-	-	10	-	-	0.4
RC13081S	Track rail end stop, silver	58	55	89	2 9/32	2 3/16	3.1
RC13081	Track rail end stop, black	58	55	89	2 9/32	2 3/16	3.1
RC1300-3.0S	Track rail, silver, 2996mm	2996	30	2430	117 15/16	1 3/16	85.7
RC1300-3.0	Track rail, black, 2996mm	2996	30	2430	117 15/16	1 3/16	85.7
RC13081P	End stop cover plate, including screws, black	-	55	16	-	2 3/16	0.6
RC13081PS	End stop cover plate, including screws, silver	-	55	16	-	2 3/16	0.6

SCREW-IN PADEYE SYSTEM DESCRIPTION

The Removable Screw-In Padeye Anchor Device consists of two parts:

- A structural anchor base which is permanently fixed to the structure.
- A screw-in anchor for connection of personal protection equipment.
 - The structural anchor base is to be permanently fastened to the structure using 4 x M6 fasteners.
 - The screw-in anchor is attached to the structural anchor base by means of a central threaded spigot. Once fully threaded in place the anti-rotation locking screw must be engaged to ensure that the anchor cannot unintentionally become detached from the structural anchor base.
 - The screw-in anchor has a single attachment point for personal protection equipment.

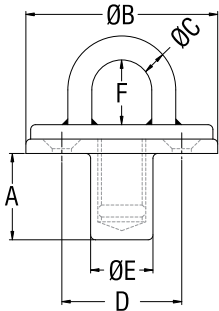
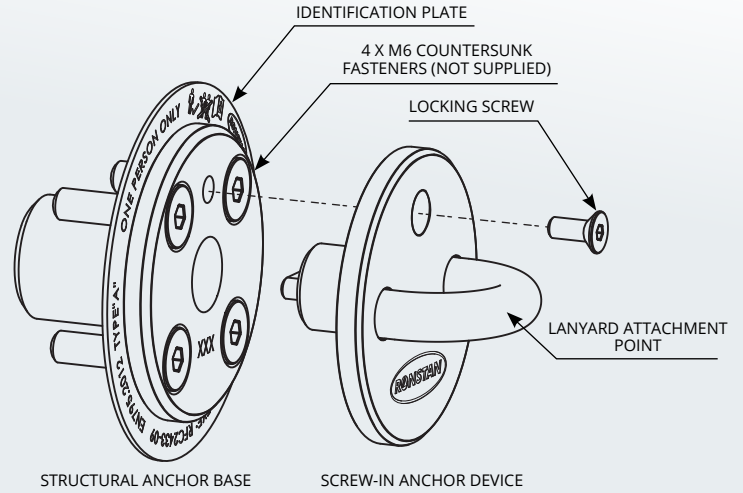

- ✓ Certified to European Standard EN795:2012 Type A for single person use and Australian Standards AS1891.4:2009 & AS5532:2013.
- ✓ Screw-in anchor for lanyard attachment can be removed from the base when not in use.
- ✓ Separate locking screw ensures that the screw-in anchor for lanyard attachment remains secure when in use.
- ✓ A threaded plug remains in the base when the screw-in anchor is removed to prevent dirt and grit from entering the threads.
- ⚙️ Grade 316 stainless steel throughout for maximum corrosion resistance and longevity.

PRODUCT No.	DESCRIPTION	A mm	B mm	C mm	D mm	E mm	F mm	WEIGHT g
-------------	-------------	------	------	------	------	------	------	----------

METRIC DIMENSIONS

Removable Screw-In Padeye Anchor Device

RFC2433-09	Certified, Screw-In Padeye, 9mm Bar	29.0	70	9.0	26.9	14.0	23.2	303
------------	-------------------------------------	------	----	-----	------	------	------	-----

PRODUCT No.	DESCRIPTION	A in	B in	C in	D in	E in	F in	WEIGHT oz
-------------	-------------	------	------	------	------	------	------	-----------

IMPERIAL DIMENSIONS

Removable Screw-In Padeye Anchor Device

RFC2433-09	Certified, Screw-In Padeye, 11/32" Bar	1 5/32	2 3/4	11/32	1 1/16	9/16	29/32	10.7
------------	--	--------	-------	-------	--------	------	-------	------