

SHACKLES



✓ Many shapes and sizes to suit any application.

✓ Coined shackle pin head - some models with hole for seizing wire.

☞ Grade 316 stainless steel bodies and pins.

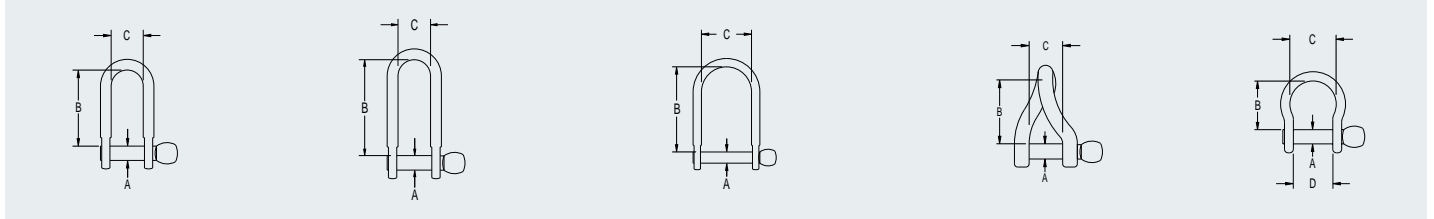

PRODUCT No.	A mm	B mm	C mm	D mm	U.D.L.*1 B.L. kg	P.L.*1 B.L. kg	WEIGHT g	A in	B in	C in	D in	U.D.L.*1 B.L. lb	P.L.*1 B.L. lb	WEIGHT oz
Standard D														
RF1851	3.2	12	9	-	375	280	2	1/8	15/32	11/32	-	825	620	0.1
RF1806	4.0	16	10	-	800	600	5	5/32	5/8	13/32	-	1760	1320	0.2
RF616	4.8	18	11	-	1200	800	15	3/16	23/32	7/16	-	2640	1760	0.5
RF617	6.4	22	14	-	2300	1400	25	1/4	7/8	9/16	-	5070	3090	0.9
RF617H*2	6.4	22	14	-	2300	1400	25	1/4	7/8	9/16	-	5070	3090	0.9
RF618	7.9	29	16	-	3600	2700	50	5/16	1 5/32	5/8	-	7940	5950	1.8
RF618H*2	7.9	29	16	-	3600	2700	50	5/16	1 5/32	5/8	-	7940	5950	1.8
RF619*2	9.5	38	17	-	5400	3600	80	3/8	1 1/2	21/32	-	11900	7940	2.8
RF620*2	12.7	42	19	-	7700	7500	130	1/2	1 31/32	3/4	-	16980	16530	4.6
RF1035	15.9	47	25	-	14000	11000	280	5/8	1 25/32	1	-	30860	24250	9.9
Long D														
RF621	4.0	26	10	-	800	600	10	5/32	1 1/32	13/32	-	1760	1320	0.4
RF622	4.8	31	11	-	1200	800	15	3/16	1 7/32	7/16	-	2640	1760	0.5
RF623	6.4	44	15	-	2300	1400	30	1/4	1 21/32	19/32	-	5070	3090	1.1
RF624	7.9	55	17	-	3600	2700	60	5/16	2 5/32	21/32	-	7940	5950	2.1
RF625*2	9.5	60	17	-	5400	3600	90	3/8	2 3/8	21/32	-	11900	7940	3.2
RF626*2	12.7	72	18	-	7700	7500	155	1/2	2 27/32	23/32	-	16980	16530	5.5
Wide														
RF1850S	3.2	11	13	-	500	280	2	1/8	7/16	1/2	-	1100	620	0.1
RF1852	4.8	29	20	-	1200	700	15	3/16	1 5/32	25/32	-	2640	1540	0.5
RF1853	6.4	39	31	-	2300	1100	26	1/4	1 17/32	1 7/32	-	5070	2430	0.9
RF639	7.9	51	28	-	3400	1700	70	5/16	2	1 3/32	-	7480	3740	2.5
RF640	9.5	56	29	-	5400	3600	95	3/8	2 7/32	1 5/32	-	11900	7940	3.4
RF641*2	12.7	68	33	-	7700	5500	170	1/2	2 11/16	1 5/16	-	16980	12130	6.0
Twisted														
RF627	4.0	23	9	-	800	600	5	5/32	29/32	11/32	-	1760	1320	0.2
RF628	4.8	28	10	-	1200	800	15	3/16	1 3/32	13/32	-	2640	1760	0.5
RF629	6.4	39	13	-	2300	1400	30	1/4	1 17/32	1/2	-	5070	3090	1.1
RF630	7.9	48	16	-	3600	2700	65	5/16	1 7/8	5/8	-	7940	5950	2.3
RF631*2	9.5	54	19	-	5400	3600	90	3/8	2 1/8	3/4	-	11900	7940	3.2
RF632*2	12.7	65	19	-	7700	7500	165	1/2	2 9/16	3/4	-	16980	16530	5.8
Bow														
RF613S*3	3.0	12	9	6.4	550	280	3	1/8	15/32	11/32	1/4	1210	620	0.1
RF633	4.0	15	17	11.0	800	600	5	5/32	9/16	9/16	7/16	1760	1320	0.2
RF634	4.8	18	14	13.0	1200	800	10	3/16	23/32	9/16	1/2	2640	1760	0.4
RF635	6.4	21	19	16.0	2300	1400	20	1/4	13/16	3/4	5/8	5070	3090	0.7
RF636	7.9	27	22	16.0	3600	2700	45	5/16	1 1/16	7/8	5/8	7940	5950	1.6
RF638*2	7.9	27	22	16.0	3600	2700	45	5/16	1 1/16	7/8	5/8	7940	5950	1.6
RF637*2	9.5	52	36	21.0	5400	3600	90	3/8	2 1/16	1 13/32	13/16	11900	7940	3.2

*1 UDL BL - The "Uniformly Distributed Load" breaking load of the shackle; the load is applied across the full span of the shackle pin.

PL BL - The "Point Load" breaking load of the shackle; the load is only applied at the centre or one side of the shackle pin.

*2 Shackle pins drilled for seizing wire

*3 RF613S has a slotted head.



- ✔ Slotted head shackle pins are low profile to prevent snagging on ropes etc.
- ✔ Lightweight clevis pin shackles use a split ring for security.
- ✔ Halyard shackles have a lever action for easy finger opening and closing. They also have a keyed pin for pin retention and spring engagement to retain pin in closed position.
- ✔ RF1320R shackle key suits both coined and slotted shackle pins, and small nylon-insert nuts.
- ✔ Grade 316 stainless steel bodies and pins.

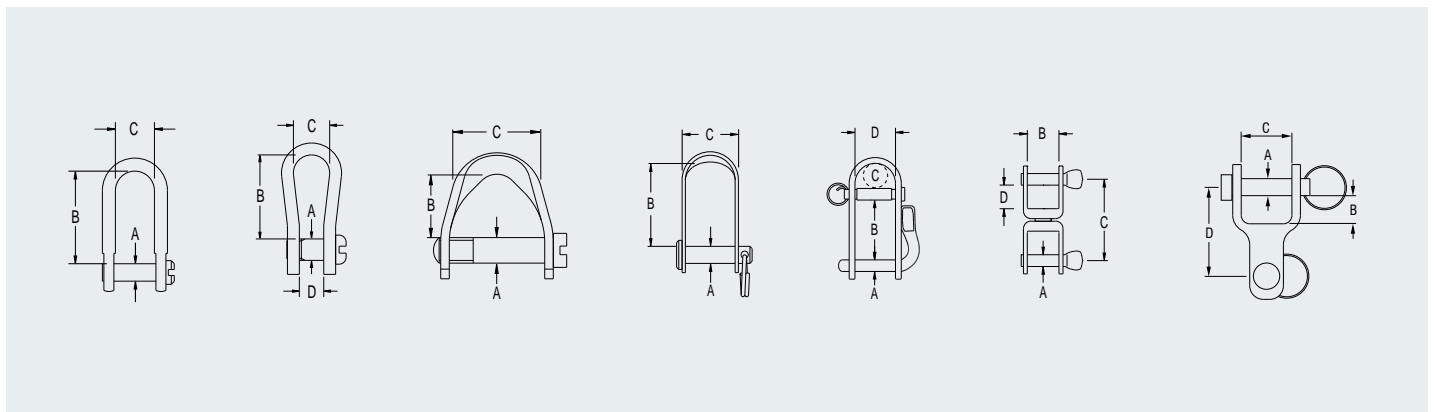

PRODUCT No.	A	B	C	D	U.D.L.*1	P.L.*1	WEIGHT	A	B	C	D	U.D.L.*1	P.L.*1	WEIGHT	
	mm	mm	mm	mm	B.L.	B.L.						lb	lb		oz
Slotted Pin															
RF615	4.0	16.0	10.0	-	850	650	5	5/32	5/8	13/32	-	1870	1430	0.2	
RF615A	4.0	13.0	8.0	-	850	700	7	5/32	1/2	5/16	-	1870	1540	0.2	
RF150	4.8	18.0	12.0	-	1500	900	10	3/16	23/32	15/32	-	3300	1980	0.4	
RF806S	4.8	11.5	16.0	-	950	700	10	3/16	7/16	5/8	-	2090	1540	0.4	
RF707S	4.8	17.0	18.0	-	1200	700	10	3/16	21/32	23/32	-	2640	1540	0.4	
RF614	4.8	19.0	10.0	5.0	1300	1300	5	3/16	13/32	3/8	3/16	2860	2860	0.2	
RF151	6.4	22.0	16.0	-	2300	1400	20	1/4	7/8	5/8	-	5070	3090	0.7	
RF152	7.9	29.0	17.0	-	3600	2700	45	5/16	1 5/32	21/32	-	7940	5950	1.6	
Lightweight Clevis Pin															
RF807	4.8	20.0	14.0	-	700	-	10	3/16	25/32	9/16	-	1540	-	0.4	
Halyard															
RF1032	4.8	22.0	10.0	15.0	1200	900	30	3/16	7/8	13/32	19/32	2650	1980	1.1	
RF1033	6.4	32.0	13.0	19.0	1800	1400	55	1/4	1 1/4	1/2	3/4	3960	3080	1.9	
RF1034	7.9	39.0	18.5	20.0	2200	1800	90	5/16	1 17/32	23/32	25/32	4840	3960	3.2	
Swivel															
RF576	4.0	10.0	22.0	6.0	500	350	10	5/32	13/32	7/8	15/64	1100	770	0.4	
RF120	4.8	12.0	32.0	8.7	650	650	20	3/16	15/32	1 1/4	11/32	1430	1430	0.7	
RF173	6.4	15.0	42.0	11.9	1100	700	40	1/4	19/32	1 21/32	19/32	2420	1540	1.4	
RF75*2	7.9	17.0	60.0	15.8	2300	2100	15	5/16	21/32	2 3/8	5/8	5070	4620	0.5	
Two-Way Link															
RF815	5.0	5.2	10.0	19.0	1100	900	14	3/16	7/32	13/32	3/4	2425	1980	0.5	
RF816	6.0	6.7	12.2	22.6	1200	1000	21	1/4	1/4	15/32	7/8	2650	2200	0.7	
Shackle Key															
RF1320R	Shackle key and multi-purpose tool. Suits coined and slotted head shackle pins. Features sockets for 3/16" & 1/4" nuts. Screwdriver tip. Hollow end ideal for tightening drain plugs. Red plastic grip handle.						90								3.2

*1 UD.L. BL - The "Uniformly Distributed Load" breaking load of the shackle; the load is applied across the full span of the shackle pin.
 PL. BL - The "Point Load" breaking load of the shackle; the load is only applied at the centre or one side of the shackle pin.
 *2 RF75 swivel shackle has stainless steel ball bearings.

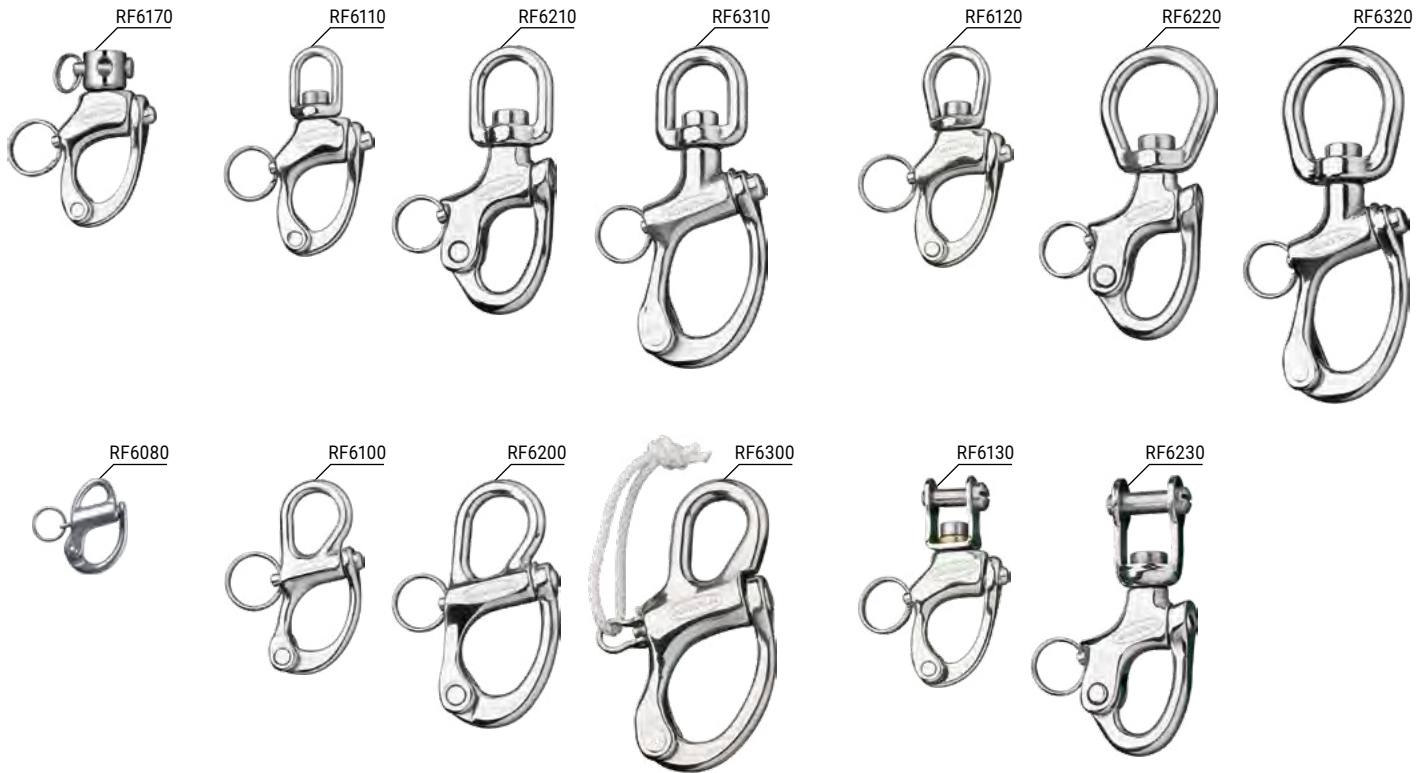

- ✔ Fixed or swivel heads.
- ✔ Heavy duty plunger springs and precision components ensure dependable service.
- ✔ Body and hasp profiles are designed for easy clearance of lines and fittings when released.
- ✔ High strength-to-weight ratio.
- ✔ Stainless steel is used throughout for excellent corrosion resistance.
- ✔ Split ring on plunger pin is spot welded for security.
- ✔ A lanyard can be attached to the plunger pin for easy opening.
- ✔ RF6170 is a snap shackle adapter for blocks with a 5mm (3/16") pin.
- ✔ Grade 15-5PH investment cast stainless steel body and hasp.
- ✔ Grade 316 stainless steel plunger pin and spring.

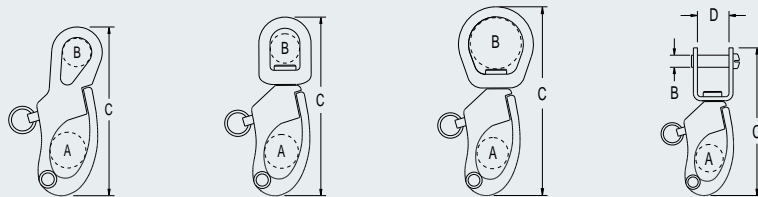

Replacement Plunger Pin Kits

RF6160	Suits RF6110, RF6120, RF6130, RF6170
RF6161	Suits RF6100
RF6260	Suits RF6200
RF6262	Suits RF6210, RF6220, RF6230, RF6230A
RF6360	Suits RF6310, RF6320
RF6361	Suits RF6300

PRODUCT No.	HEAD TYPE	A mm	B mm	C mm	D mm	M.W.L. kg	B.L. kg	WEIGHT g	A in	B in	C in	D in	M.W.L. lb	B.L. lb	WEIGHT oz
Series 80															
RF6080	Fixed bail	6.2	4.7	32	-	75	150	10	1/4	3/16	1 1/4	-	165	330	0.4
Series 100															
RF6100	Fixed bail	16	15.0	66	-	1000	2000	43	5/8	19/32	2 19/32	-	2200	4410	1.5
RF6110	Small swivel bail	16	10.0	69	-	850	1700	50	5/8	13/32	2 23/32	-	1870	3750	1.8
RF6120	Large swivel bail	16	13.0	73	-	750	1500	57	5/8	1/2	2 7/8	-	1650	3310	2.0
RF6130	Swivel shackle	16	6.4	72	13	750	1500	64	5/8	1/4	2 27/32	1/2	1650	3310	2.3
RF6170	Block head adapter	16	5.0	60	-	500	1000	49	5/8	3/16	2 3/8	-	1100	2200	1.7
Series 200															
RF6200	Fixed bail	20	19.0	85	-	1100	2200	100	13/16	3/4	3 11/32	-	2420	4840	3.5
RF6210	Small swivel bail	16	16.0	92	-	1600	3200	113	5/8	5/8	3 5/8	-	3530	7050	4.0
RF6220	Large swivel bail	16	25.0	101	-	1100	2200	120	5/8	1	3 31/32	-	2430	4850	4.2
RF6230	Swivel shackle	16	7.9	95	17.5	1100	2200	120	5/8	5/16	3 3/4	11/16	2430	4850	4.2
Series 300															
RF6300	Fixed bail	26	19.0	100	-	2000	4000	155	1 1/32	3/4	3 15/16	-	4410	8820	5.5
RF6310	Small swivel bail	26	16.0	110	-	1800	3600	142	1 1/32	5/8	4 11/32	-	3970	7940	5.0
RF6320	Large swivel bail	26	26.0	122	-	1350	2700	170	1 1/32	1 1/32	4 3/4	-	2980	5950	6.0

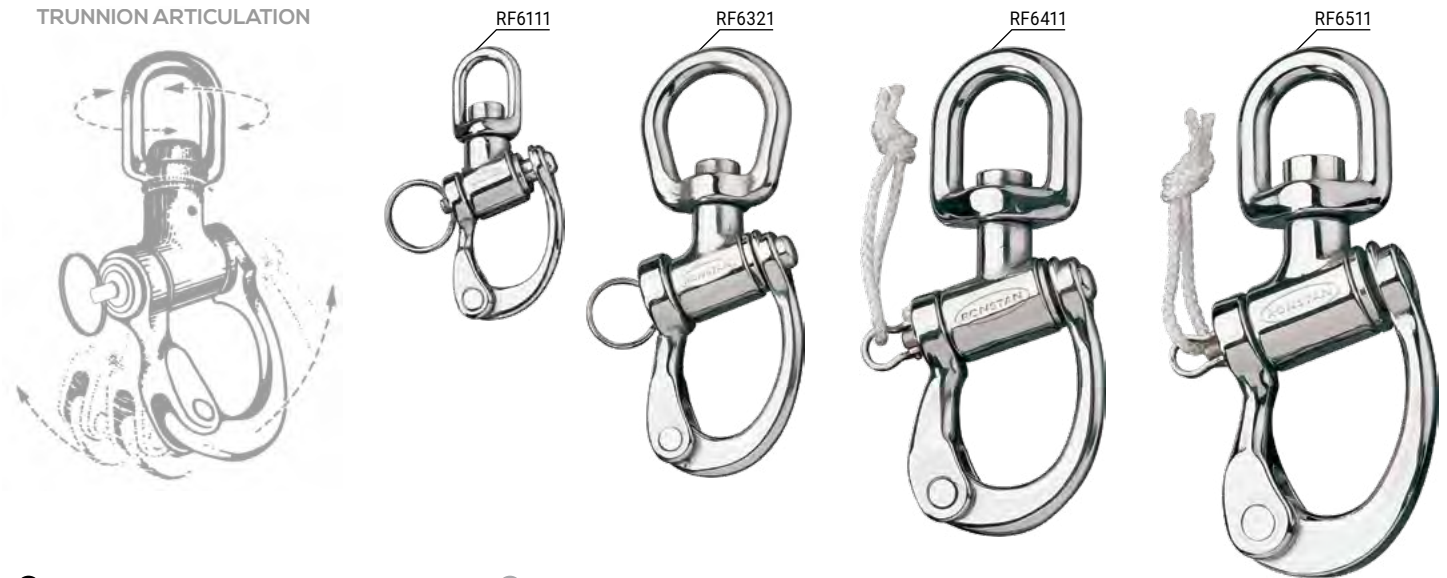

© Graham Snook Photography

TRUNNION ARTICULATION

✔ Trunnion swivel head allows both 360° rotation and sided to side articulation.

✔ Small and large bail versions.

✔ Grade 15-5PH investment cast stainless steel body and hasp.

✔ Stainless steel plunger pin and spring.

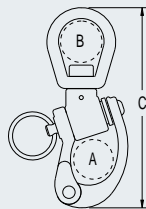
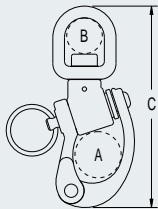

Replacement Plunger Pin Kits

RF6161	Suits RF6111
RF6360	Suits RF6321
RF6461	Suits RF6411
RF6561	Suits RF6511

PRODUCT No.	HEAD TYPE	A mm	B mm	C mm	M.W.L. kg	B.L. kg	WEIGHT g	A in	B in	C in	M.W.L. lb	B.L. lb	WEIGHT oz
Series 100													
RF6111	Small swivel bail	16	10	70	750	1500	57	5/8	13/32	2 3/4	1650	3310	2.0
Series 300													
RF6321	Large swivel bail	26	26	122	1350	2700	198	1 1/32	1 1/32	4 13/16	2980	5950	7.0
Series 400													
RF6411	Small swivel bail	32	25	137	3000	6000	369	1 1/4	1	5 13/32	6610	13230	13.0
Series 500													
RF6511	Small swivel bail	36	22	150	3750	7500	454	1 13/32	7/8	5 29/32	8270	16530	16.0

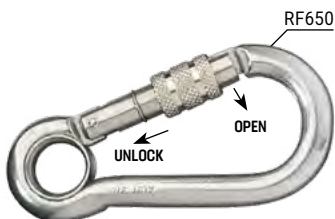

CARABINER HOOKS, NON-LOCKING



CARABINER HOOK, LOCKING



QUICKLINKS



ROUND RINGS



D-RING



SNAP HOOK

- ✔ Carabiner hooks have ferrule lined eyes to retain the fixed line.
- ✔ RF650 carabiner hook opens inwards and has a threaded locking sleeve for added security.
- ✔ Quicklinks have large openings and secure threaded locking sleeves.
- ✔ RF16 D-ring suits use with 50mm (2") webbing.

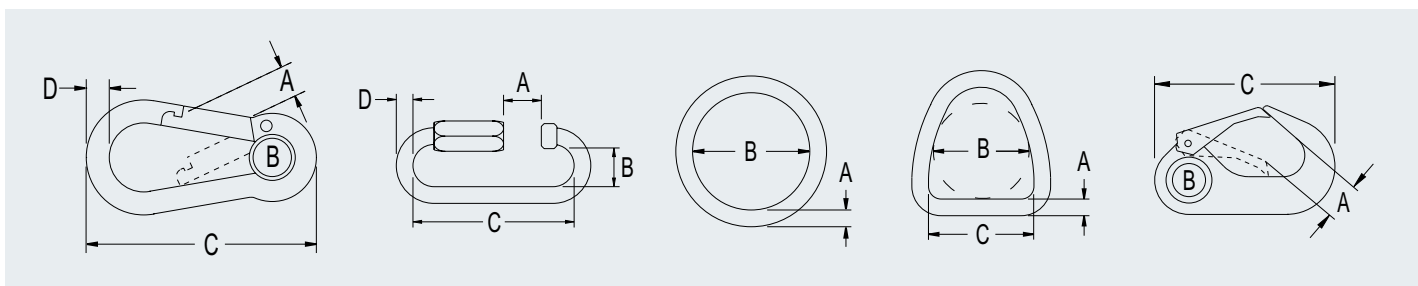

PRODUCT No.	TYPE	A mm	B mm	C mm	D mm	M.W.L. kg	B.L. kg	WEIGHT g	A in	B in	C in	D in	M.W.L. lb	B.L. lb	WEIGHT oz	
Carabiner Hooks - Non-Locking																
RF2355	-	9.0	9.0	60	6	-	520	28	11/32	11/32	2 3/8	1/4	-	1145	1.0	
RF652	-	11.0	11.0	80	8	-	800	68	7/16	7/16	3 1/8	5/16	-	1760	2.4	
RF653	-	15.0	15.0	100	10	-	1200	129	19/32	19/32	3 15/16	13/32	-	2640	4.6	
Carabiner Hook - Threaded Locking Sleeve																
RF650	-	13.0	14.0	100	10	-	1200	134	17/32	17/32	3 15/16	13/32	-	2640	4.7	
Quicklinks																
RF711	-	5.5	11.5	32	4	-	1400	12	3/16	7/16	1 1/4	5/32	-	3085	0.4	
RF712	-	7.5	14.5	45	6	-	3250	35	5/16	9/16	1 3/4	1/4	-	7165	1.2	
RF713	-	11.0	17.5	58	8	-	5500	79	7/16	11/16	2 5/16	5/16	-	12125	2.7	
RF714	-	12.0	20.5	69	10	-	9000	140	15/32	13/16	2 11/16	13/32	-	19840	4.9	
Rings																
RF122	Round	4.0	38.0	-	-	180	1100	12	5/32	1 1/2	-	-	396	2420	0.4	
RF123	Round	5.0	25.4	-	-	600	2200	14	3/16	1	-	-	1320	4840	0.5	
RF48	Round	6.0	25.4	-	-	900	3000	15	1/4	1	-	-	1980	6600	0.5	
RF124	Round	6.0	38.0	-	-	650	3000	40	1/4	1 1/2	-	-	1430	6600	1.4	
RF125	Round	8.0	42.5	-	-	700	3500	55	5/16	1 5/8	-	-	1540	7700	1.9	
RF16	D-ring	8.0	45.0	50	-	600	1200	75	5/16	1 3/4	2	-	1320	2640	2.7	
Snap Hook																
RF533	-	10.0	9.0	51	-	180	360	25	13/32	11/32	2	-	395	790	0.9	



SWIVELS
See page 203 for swivel shackles

S-HOOKS

BECKETTS

SISTER CLIPS

Swivels are used in conjunction with blocks and rigging systems to provide articulation and rotation (not suitable for high speed rotating applications).

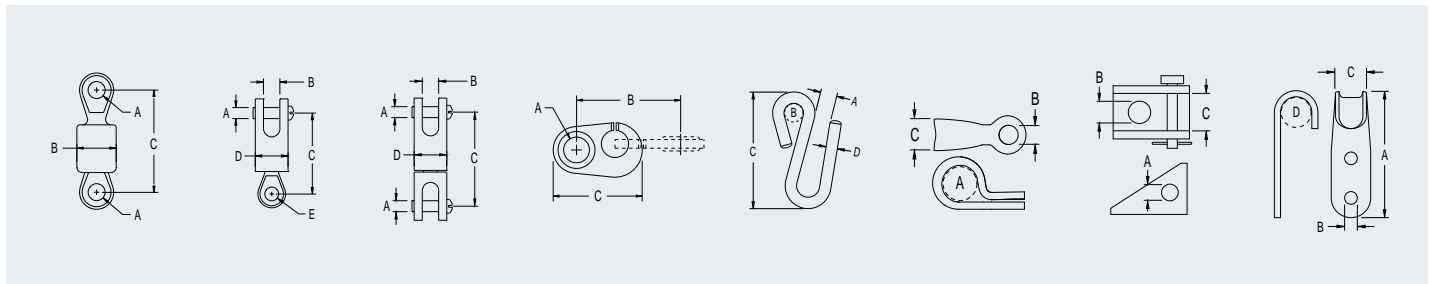
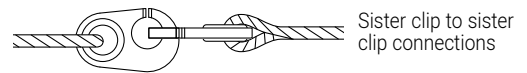

PRODUCT No.	TYPE	A	B	C	D	E	B.L.	WEIGHT	A	B	C	D	E	B.L.	WEIGHT
		mm	mm	mm	mm	mm	kg	g	in	in	in	in	in	lb	oz
Swivels - Ball Bearing															
RF78*		8.1	19.1	51.8	-	-	1000	65	5/16	3/4	2 3/32	-	-	2200	2.3
RF78A		6.4	9.6	54.0	19.0	-	1700	80	1/4	3/8	2 1/8	3/4	-	3740	2.8
RF78B*		6.4	9.6	44.3	19.0	8.1	1700	60	1/4	3/8	1 3/4	3/4	5/16	3740	2.1
RF79		7.9	12.7	89.8	25.1	16.0	2600	190	5/16	1/2	3 17/32	1	5/8	5720	6.7
Sister Clips															
RF536		7.0	27.0	24.0	-	-	70	5	9/32	1 1/16	15/16	-	-	150	0.2
RF89		10.0	43.0	37.0	-	-	250	10	13/32	1 11/16	1 7/16	-	-	550	0.4
RF2665		15.0	60.0	58.0	-	-	1800	81	19/32	2 3/8	2 1/4	-	-	3960	2.9
S-Hooks															
RF50		10.0	6.8	44.0	4.8	-	250	14	13/32	1/4	1 3/4	3/16	-	550	0.5
RF48A		10.0	9.0	62.0	6.0	-	400	35	13/32	11/32	2 7/16	1/4	-	880	1.2
RF49		12.0	11.0	76.0	8.0	-	600	65	15/32	7/16	3	5/16	-	1320	2.3
RF51		15.0	16.0	87.0	9.5	-	800	110	19/32	5/8	3 7/16	3/8	-	1760	3.9
Becketts															
RF88	Hook becket	50.5	5.0	13.5	8.0	-	-	13	2	3/16	17/32	5/16	-	-	0.5
RF1050	Eye becket	8.0	5.0	9.0	-	-	-	6	5/16	3/16	11/32	-	-	-	0.2
RF1051	Eye becket	8.0	6.0	9.0	-	-	-	6	5/16	1/4	11/32	-	-	-	0.2
RF1052	Fork becket / block anchor	5.0	5.0	11.5	-	-	-	9	3/16	3/16	7/16	-	-	-	0.3
RF1053	Fork becket / block anchor	5.0	6.0	14.0	-	-	-	9	3/16	1/4	9/16	-	-	-	0.3

*Eye thickness = 6.4mm (1/4")

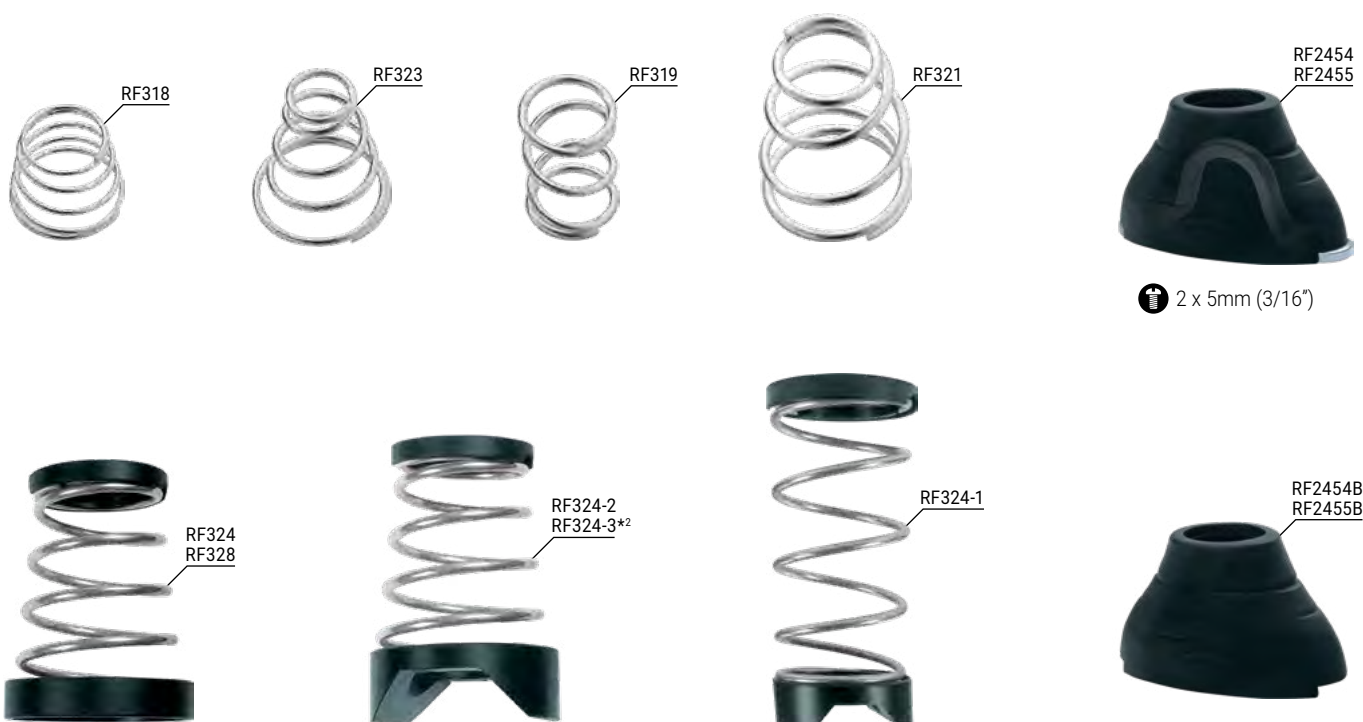

2 x 5mm (3/16")

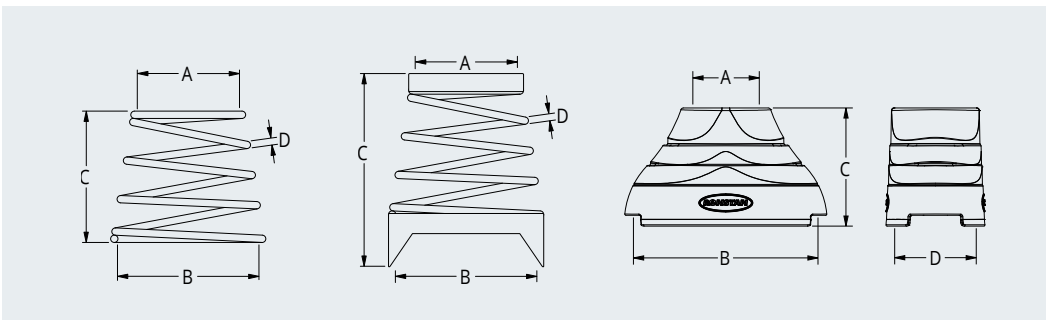

- ☑ RF324, RF324-1, RF324-2, RF324-3, RF328 include top and bottom acetal collars.
- ⬆ Springs and boots are used to support blocks in an upright position.
- 🔄 Grade 316 stainless steel springs.

PRODUCT No.	DESCRIPTION	A	B	C	D	WEIGHT	A	B	C	D	WEIGHT
		mm	mm	mm	mm	g	in	in	in	in	oz
Stand-Up Springs											
RF318*1	Stand-up spring, suits Series 15 and Series 20 Utility blocks with saddle RF498	16	23	22	1	3	5/8	7/8	7/8	1/32	0.1
RF319	Stand-up spring	16	16	32	2	3	5/8	5/8	1 1/4	3/32	0.1
RF321*1	Stand-up spring, suits Series 40 Utility blocks (use saddle RF134 or RF134A) or Series 50 (use saddle RF1055)	16	24	41	2	9	5/8	15/16	1 5/8	3/32	0.3
RF323*1	Stand-up spring, suits Series 30 Utility blocks and Orbit Blocks™ with saddle RF134/RF134A	19	25	32	1	4	3/4	1	1 1/4	1/32	0.1
RF324	Stand-up spring, suits Series 60 & 75 Core Blocks™ and Orbit Blocks™ with padeye RF2433-09	20	30	81	4	80	3/4	1 3/16	3 3/16	5/32	2.8
RF324-1	Stand-up spring, suits Series 60 & 75 Core Blocks™ and Orbit Blocks™	20	24	103	3	60	3/4	15/16	4 1/16	1/8	2.1
RF324-2	Stand-up spring, suits Series 60 & 75 Core Blocks™ and Orbit Blocks™, S26 & S30 traveller cars	20	38	89	4	60	3/4	1 1/2	3 1/2	5/32	2.1
RF324-3*2	Stand-up spring, suits Series 60, 75 & 100 Core Blocks™ and Orbit Blocks™, S26 traveller cars	20	38	94	4	60	3/4	1 1/2	3 11/16	5/32	2.1
RF328	Stand-up spring, suits S100 Orbit Blocks™ with padeye RF2429-10	47	72	95	4	120	1 7/8	2 7/8	3 3/4	5/32	4.2
Stand-Up Bases & Boots											
RF2454	Stand-up base, suits S40 Orbit Blocks™ - includes RF134 stainless steel saddle	17	42	28	19	11	5/8	1 5/8	1 1/8	3/4	0.4
RF2455	Stand-up base, suits S55 Orbit Blocks™ - includes RF1055 stainless steel saddle	20	53	35	23	26	3/4	2 1/8	1 3/8	15/16	0.9
RF2454B	Stand-up boot, suits S40 Orbit Blocks™ - boot only	17	42	28	19	6	5/8	1 5/8	1 1/8	3/4	0.2
RF2455B	Stand-up boot, suits S55 Orbit Blocks™ - boot only	20	53	35	23	11	3/4	2 1/8	1 3/8	15/16	0.4

*1 Tapered spring.
*2 Suits no end cap version Series 26 traveller cars.



PADEYES



SADDLES - NARROW

SADDLES - FLARED TOP

SADDLE - FLARED TOP

SADDLES - FERRULE EYE

- Grade 316 stainless steel.
- RF2429-xx - Grade 15-5PH stainless steel.

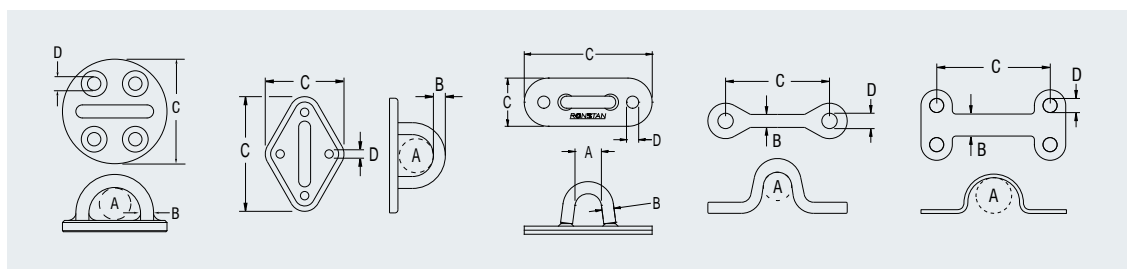

PRODUCT No.	DESCRIPTION	A	B	C	D	B.L.	WEIGHT	A	B	C	D	B.L.	WEIGHT
		mm	mm	mm	mm	kg	g	in	in	in	in	lb	oz
Padeyes - Fixed, Round													
RF2429-02	2 mounting holes	7.2	5.0	34.0	6.4	1500**2	26	9/32	3/16	1 5/16	1/4	3310**2	0.9
RF2429-06	4 mounting holes	16.0	7.3	50.0	6.4	4000**2	82	5/8	5/16	2	1/4	8800**2	2.9
RF2429-08	4 mounting holes	17.2	10.0	57.7	8.3	6000**2	127	43/64	25/64	2 1/4	21/64	13200**2	4.5
RF2429-10	4 mounting holes	21.1	11.5	72.3	10.2	9000**2	240	53/64	7/16	2 3/4	13/32	19800**2	8.5
Padeyes - Fixed, Diamond Base													
RF87	Straight sided, concave underside	10.0	5.0	51 x 19	5.1	-	15	3/8	3/16	2 x 3/4	3/16	-	0.5
RF529*	Includes nylon mounting pad	18.0	8.0	75 x 51	6.4	2000	100	23/32	5/16	3 x 2	1/4	4400	4.0
RF415	Includes nylon mounting pad	21.0	8.0	75 x 51	5.0	1000	75	13/16	5/16	3 x 2	3/16	2200	2.7
RF44	Includes nylon mounting pad	22.0	11.0	94 x 60	6.7	2000	130	7/8	7/16	3 11/16 x 2 3/8	1/4	4400	4.6
RF416		25.0	6.4	83 x 35	4.8	800	40	1	1/4	3 1/4 x 1 3/8	3/16	1760	1.4
Saddles - Narrow													
RF133		9.0	4.0	27.0	4.8	-	2	3/8	5/32	1 1/16	3/16	-	0.1
RF134		14.0	5.1	36.6	4.5	-	5	9/16	3/16	1 7/16	3/16	-	0.2
RF134A	Countersunk holes	14.0	5.1	36.6	5.0	-	5	9/16	3/16	1 7/16	3/16	-	0.2
RF498		12.0	3.2	27.7	4.3	-	4	15/32	1/8	1 3/32	5/32	-	0.1
RF528		12.0	6.8	44.5	8.1	-	25	15/32	9/32	1 23/32	5/16	-	0.9
RF1054		18.0	7.0	60.0	8.4	-	35	23/32	9/32	2 3/8	5/16	-	1.2
RF1055		16.0	5.8	43.0	6.6	-	15	5/8	7/32	1 11/16	1/4	-	0.5
Saddles - Flared Top													
RF94		6.0	9.0	27.0	5.0	-	3	1/4	11/32	1 1/16	3/16	-	0.1
RF94A		5.0	5.8	29.0	5.0	-	3	3/16	7/32	1 1/8	3/16	-	0.1
RF96		10.0	8.3	29.0	6.4	-	5	3/8	5/16	1 1/8	1/4	-	0.2
RF148		15.0	11.0	40.0	6.5	-	8	9/32	7/16	1 5/8	1/4	-	0.3
RF291		12.0	9.0	31.8	5.3	-	7	1/2	11/32	1 1/4	3/16	-	0.2
RF4714	4 fixing points	9.0	8.0	32.0 / 19.5	5.0	-	9	11/32	5/16	1 1/4 / 3/4	3/16	-	0.3
RF5003		7.0	9.0	27.0	5.0	-	4	1/4	3/8	1 1/16	3/16	-	0.1
RF5013		15.0	12.5	38.1	5.0	-	8	5/8	1/2	1 1/2	3/16	-	0.3
RF5023		18.0	14.0	51.0	6.6	-	11	3/4	9/16	2	1/4	-	0.4
Saddles - Ferrule Eye													
RF499		9.4	4.9	27.7	4.3	-	4	3/8	3/16	1 3/32	5/32	-	0.1
RF1056		16.3	8.8	60.0	8.4	-	40	5/8	5/16	2 3/8	5/16	-	1.4
RF1057		13.0	6.8	45.7	6.6	-	18	1/2	1/4	1 3/4	1/4	-	0.6
RF1058		10.0	9.0	36.6	5.1	-	11	3/8	11/32	1 7/16	3/16	-	0.4

* Turned U-Bolt with a pad eye base. Thread size is 6.4mm (1/4" UNC). Suits maximum deck thickness of 22mm (7/8")
 ** A4-80 DIN7991 grade fasteners recommended to achieve BL



© Sport Sailing Photography

- RF2433-09 4 X M6
- RF2433-10 4 X M8
- RF2435-14 4 X M10



REMOVABLE

- RF2435-12B 4 X M8
- RF2435-16B 4 X M10
- RF2435-20B 6 X M12



REMOVABLE, NON-TUMBLE

- RF2436-06 3 X M6
- RF2436-08 3 X M8
- RF2436-10 3 X M10



FOLDING

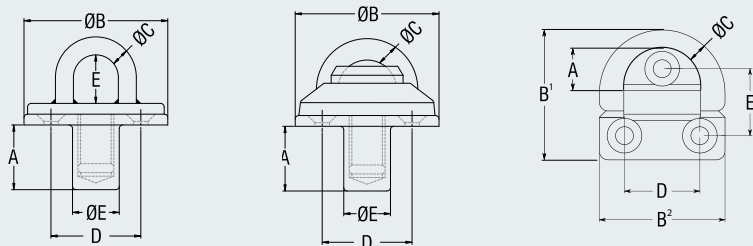

- ✔ Screw in, removable padeyes allow the block and padeye to be easily removed when not in use.
- ✔ Integral threaded plug in removable padeyes prevents grit from entering the threaded socket when the padeye is removed.
- ✔ Folding padeyes provide a low profile solution with the eye pivoting upright when required for use.
- ✔ Removable screw-in padeyes are ideal for attaching blocks which may be removed when not in use or while cruising. A threaded plug remains in the base section when the top plate is removed to prevent dirt and grit from entering the threads.
- ✔ Hand-polished finish.
- ✔ Grade 316 stainless steel.

PRODUCT No.	DESCRIPTION	A mm	B mm	C mm	D mm	E mm	F mm	M.W.L. kg	B.L.* ³ kg	WEIGHT g	A in	B in	C in	D in	E in	F in	M.W.L. lb	B.L.* ³ lb	WEIGHT oz
RF2435-12B	Removable, non-tumble	36	80	12.0	50.0	26	-	4000	8000	560	1 7/16	3 5/32	15/32	1 31/32	1 1/32	-	8800	17600	19.8
RF2433-09	Removable	30	55	9.0	38.0	14	23	2000	4000	285	1 3/16	2 5/32	11/32	1 1/2	9/16	29/32	4410	8820	10.1
RF2433-10	Removable	32	72	10.0	99.5	19	30	2500	5000	550	1 1/4	2 27/32	13/32	1 15/16	3/4	1 3/16	5510	11020	19.4
RF2435-14	Removable	40	100	14.0	70.0	32	32	7500	15000	1100	1 9/16	3 15/16	9/16	2 3/4	1 1/4	1 1/4	16530	33070	38.8
RF2435-16B	Removable, non-tumble	40	100	16.0	70.0	-	-	8000	16000	2200	1 9/16	3 15/16	5/8	2 3/4	1 1/4	-	17640	35270	77.6
RF2435-20B	Removable, non-tumble	52	135	19.8	74.5	-	-	13500	27000	3700	2 1/16	5 5/16	25/32	2 15/16	-	-	29760	59520	130.4
RF2436-06	Folding	13.5* ¹	46.5 x 45* ²	7.7	27.0	24	-	1100	2200	74	1/2* ¹	1 7/8 x 1 13/16* ²	5/16	1 1/16	-	-	2420	4840	2.6
RF2436-08	Folding	18.5* ¹	61 x 59* ²	10.4	35.0	29.5	-	2000	4000	172	1 1/16* ¹	2 7/16 x 2 3/8* ²	7/16	1 3/8	1 5/32	-	4400	8800	6.1
RF2436-10	Folding	23.5* ¹	77 x 75* ²	13.2	45.0	39	-	3650	7300	356	7/8* ¹	3 1/16 x 3* ²	9/16	1 3/4	1 17/32	-	8030	16060	12.6

*1 Eye clearance when upright.

*2 B' x B²

*3 A4-80 DIN7991 grade fasteners recommended to achieve BL